

# PRODUCT DATA SHEET

## ET1050 Low Speed Torquemeter

### Model Rating

Maximum Continuous Torque: 50Nm  
 Maximum Continuous Speed: 20000rpm

Shaft Rating Range 3Nm to 50Nm  
 Accuracy at Full Scale Torque 0.12% Application Dependant

### Specification

Number of Bearings	2
Bearing Temp. Monitoring	None
Bearing Lubrication Type	Grease
Accelerometer Mounting	None
Rotastat Voltage	See GDS01



### Environment

Storage Temperature	-50 to 85°C
Operating Temperature	-20 to 80°C

### Outline Drawing

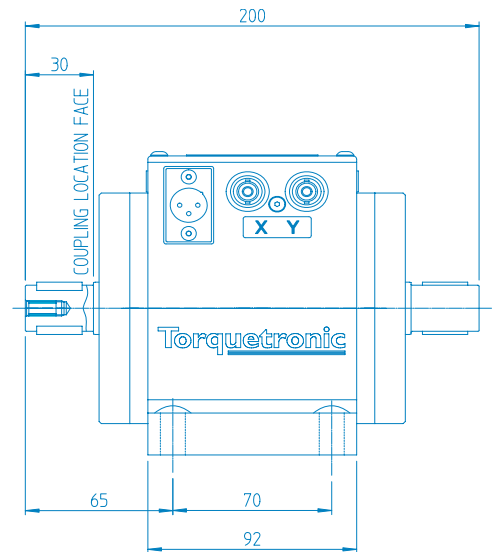
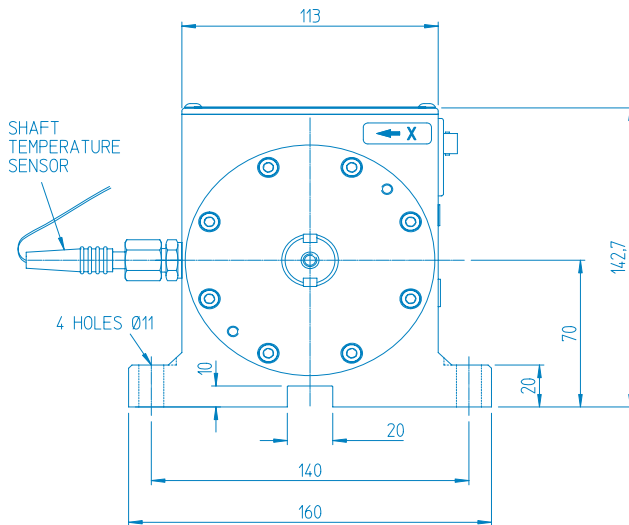

Overall Weight 10kg

### For more detail see drawings

INST02-1050-00	For installation drawing
02-1050-00	For itemized assembly drawing
E850001	For typical electrical connection drawing
03-1050-00	For drawing of optional calibration tooling



**Torquemeters Limited**  
 Ravensthorpe, Northampton, NN6 8ET, United Kingdom.  
 Telephone: +44 (0)1604 770232 Fax: +44 (0)1604 770778  
 email: info@torquemeters.com www.torquemeters.com

**Torquemeters** LIMITED  
 high performance test & measurement systems

### Coupling Specification

Shaft End Type	2off Opposite Shallow Keys
Nominal Size	Ø17mm

### Bearing Lubrication Requirements

Lubrication type	Semi Synthetic Grease
Grease type	Shell Nerita HV Grease
Grease quantity	0.3 ml

### Cartridge Style

Interchangeable torsion shafts for ET1050 supplied as bearings and shaft only.

#### Permissible Speed vs CofG Overhang

Dependant on application.  
Please contact Torquemeters Ltd

#### Inertia and Torsional Stiffness vs Shaft Rating

Dependant on application.  
Please contact Torquemeters Ltd

Please refer to Technical Data Sheet (TDS01) for details of Torquetronic Torquemeter phase shift system.  
Please refer to Generic Data Sheet (GDS01) for details of Torquemeter options.