

PRODUCT DATA SHEET

ET1105 High Speed Torquemeter

Model Rating

Maximum Continuous Torque: 100Nm

Maximum Continuous Speed: 8000rpm

Shaft Rating Range 10Nm to 100Nm

Accuracy at Full Scale Torque 0.12% Application Dependant

Specification

Number of Bearings	4
Bearing Temp. Quantity	1 Per Bearing
Bearing Temp. Monitoring	See GDS01
Bearing Lubrication Type	Oil
Fluid Port Type	See GDS01
Accelerometer Mounting	2-off Each End. See GDS01
Rotastat Voltage	See GDS01



Environment

Storage Temperature	-50 to 85°C
Operating Temperature	-20 to 80°C

Outline Drawing

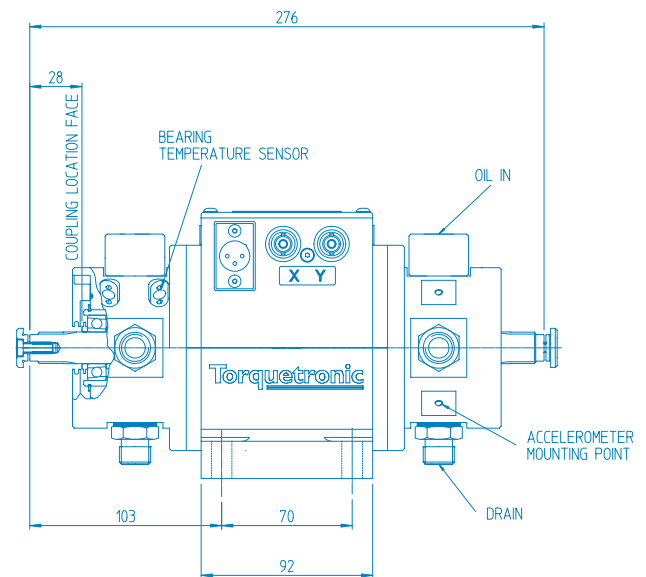
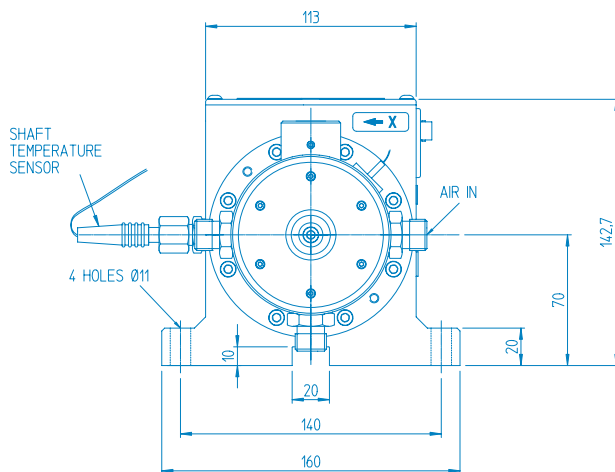

Overall Weight 10kg

For more detail see drawings

INST02-1105-00	For installation drawing
02-1105-00	For itemized assembly drawing
E850001	For typical electrical connection drawing
03-1105-00	For drawing of optional calibration tooling
06-1105-00 & 06-1105-01	For optional bearing removal and refitting tooling



Torquemeters Limited

Ravensthorpe, Northampton, NN6 8ET, United Kingdom.
 Telephone: +44 (0)1604 770232 Fax: +44 (0)1604 770778
 email: info@torquemeters.com www.torquemeters.com



Coupling Specification

Recommended Coupling	TORDISC LM110
Shaft End Type	Splined DIN 5480 – 17 x 1 x 15 x 7H 8f
Shaft Diameter Nominal	17mm

Bearing Lubrication Requirements

Lubrication Type	Oil Jet
Oil type	ISO VG32
Oil inlet temperature	35 ± 5 °C
Oil supply pressure	200 ± 50 kPa
Oil quantity	85 l/hr @ 200kPa
Oil filtration	10 µm

Seal Air Supply Requirements

Air pressure	4 ± 1 kPa
Air quantity	50 m ³ /hr

Cartridge Style

Interchangeable torsion shafts for ET1105 supplied with bearings as a cartridge assembly

Permissible Speed vs Coupling C of G Overhang

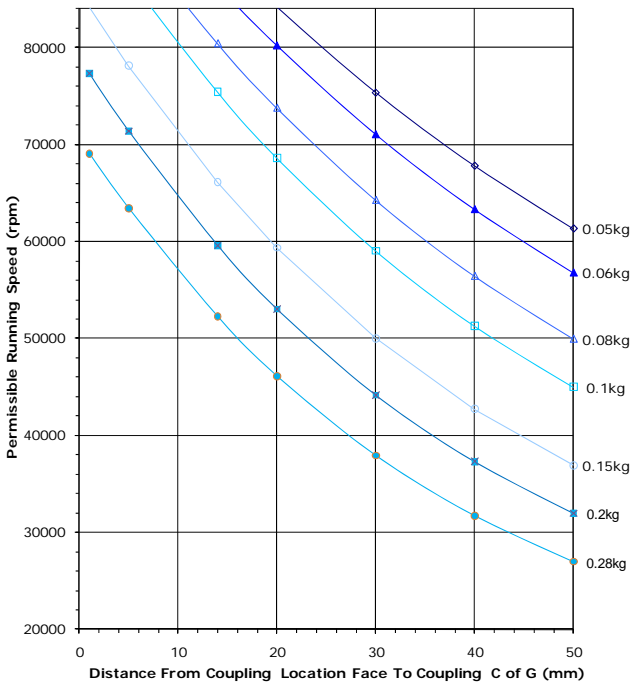

Inertia and Torsional Stiffness vs Shaft Rating

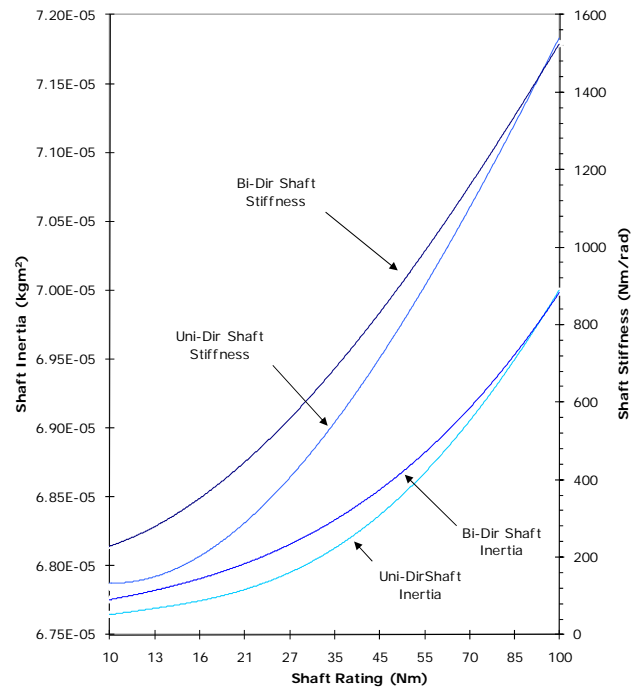

Please refer to Technical Data Sheet (TDS01) for details of Torquetric Torquemeter phase shift system.
Please refer to Generic Data Sheet (GDS01) for details of Torquemeter options.