

# PRODUCT DATA SHEET

## ET1185 High Speed Torquemeter

### Model Rating

Maximum Continuous Torque: 180Nm

Maximum Continuous Speed: 60000rpm

Shaft Rating Range 16Nm to 180Nm

Accuracy at Full Scale Torque 0.12% Application Dependant

### Specification

Number of Bearings	4
Bearing Temp. Quantity	1 Per Bearing
Bearing Temp. Monitoring	See GDS01
Bearing Lubrication Type	Oil
Fluid Port Type	See GDS01
Accelerometer Mounting	2-off Each End. See GDS01
Rotastat Voltage	See GDS01

### Environment

Storage Temperature	-50 to 85°C
Operating Temperature	-20 to 80°C



### Outline Drawing

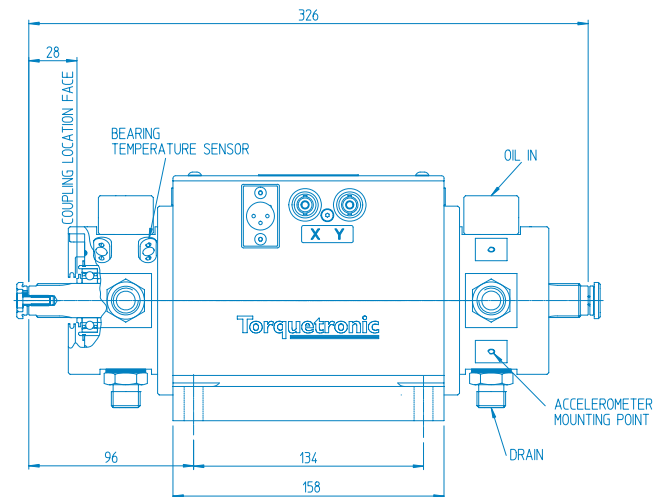
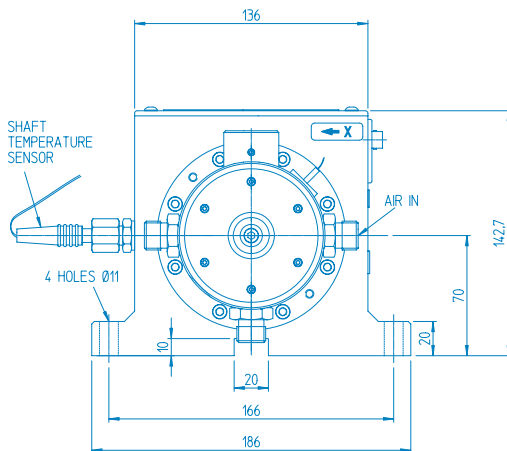

Overall Weight 11kg

### For more detail see drawings

INST02-1185-00	For installation drawing
02-1185-00	For itemized assembly drawing
E850001	For typical electrical connection drawing
03-1185-00	For drawing of optional calibration tooling
06-1185-00 & 06-1185-01	For optional bearing removal and refitting tooling



Torquemeters Limited

Ravensthorpe, Northampton, NN6 8ET, United Kingdom.  
Telephone: +44 (0)1604 770232 Fax: +44 (0)1604 770778  
email: info@torquemeters.com www.torquemeters.com

**Torquemeters** LIMITED  
high performance test & measurement systems

### Coupling Specification

Recommended Coupling	TORDISC LM118
Shaft End Type	Splined DIN 5480 – 20 x 1 x 18 x 7H 8f
Shaft Diameter Nominal	20mm

### Bearing Lubrication Requirements

Lubrication Type	Oil Jet
Oil type	ISO VG32
Oil inlet temperature	35 ± 5 °C
Oil supply pressure	200 ± 50 kPa
Oil quantity	85 l/hr @ 200kPa
Oil filtration	10 µm

### Seal Air Supply Requirements

Air pressure	4 ± 1 kPa
Air quantity	50 m <sup>3</sup> /hr

### Cartridge Style

Interchangeable torsion shafts for ET1185 supplied with bearings as a cartridge assembly

Permissible Speed vs Coupling C of G Overhang

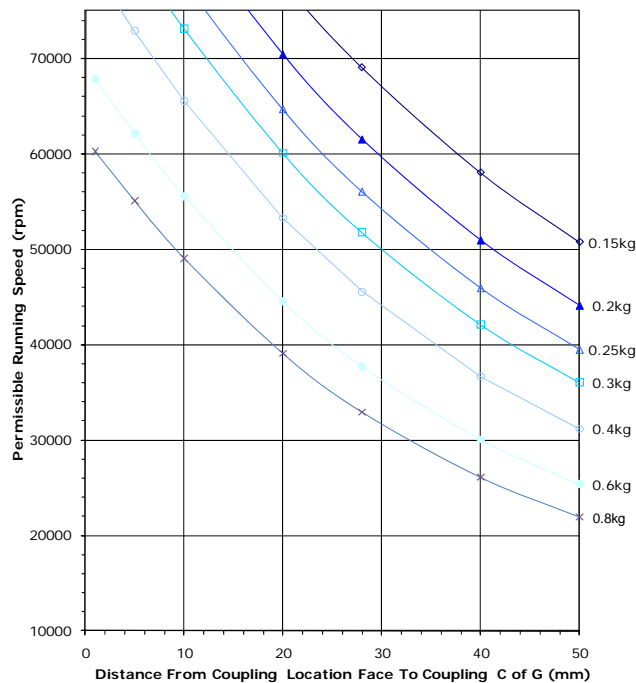

Inertia and Torsional Stiffness vs Shaft Rating

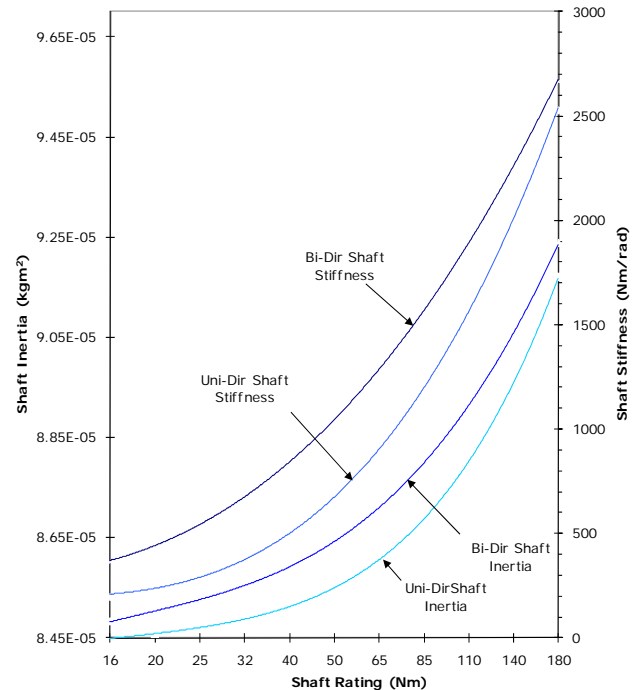

Please refer to Technical Data Sheet (TDS01) for details of Torquetric Torquemeter phase shift system.  
Please refer to Generic Data Sheet (GDS01) for details of Torquemeter options.